

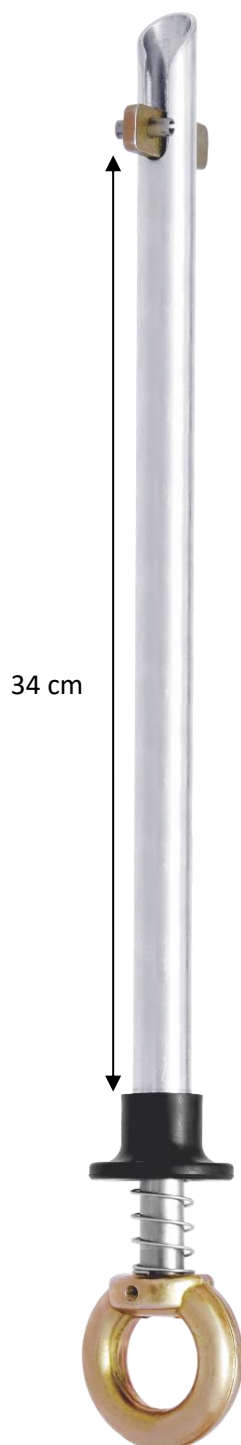

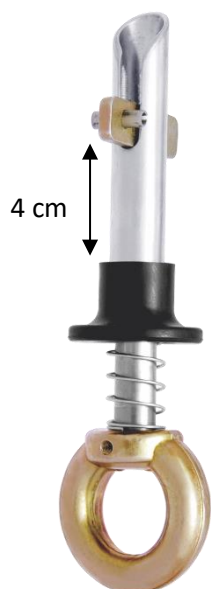

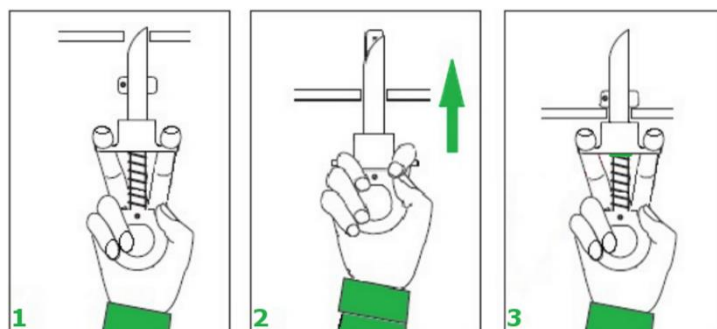

# IN LOCK-2

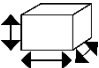

<b>HS CODE</b>
83081000
<b>CARTON SIZE / PCS.</b>
<b>FA 60 019 00:</b> 40 x 30 x 24 cm / 20
<b>FA 60 019 01:</b> 60 x 40 x 24 cm / 15
AET (UE) N°2777/10795-03/E01-01
<b>Satra Technology Europe Ltd., N° 2777,</b> Bracetown Business Park, Clonee, Dublin, D15YN2P, Ireland
<b>MODULE D IN14/14003.01</b>
<b>SGS Fimko Oy, N°0598</b> Takomotie 8, 00380 HELSINKI, Finland
AET (UKCA) N°AB0321/16000-01/E01-01
<b>Satra Technology Centre, N°0321</b> Wyndham Way, Telford Way, Kettering Northamptonshire, NN16 8SD, United Kingdom
<b>MODULE D 11 IN14/14003</b>
<b>SGS United Kingdom Ltd., N°0120</b> Unit 202B, Worle Parkway, Weston-super-Mare, BS22 6WA, United Kingdom

REF.	FA 60 019 00   FA 60 019 01
CE	EN 795:2012 Type B
	x1
MAT.	
R (kN) / MBS (kN)	12 kN / 23 kN
	Ø 22-23 mm
	0.55 KG   1.25 kg



**Nombre d'utilisateurs**  
Number of users  
**Cantidad de usuarios**  
Quantità di utilizzatori  
**Anzahl der Benutzer**

**R (kN) / MBS (kN)**

**Résistance statique (en kN) / Résistance à la rupture**  
Static strength / Minimum Breaking Strength  
**Resistencia estática (en kN) / Resistencia a la ruptura (en kN)**  
Resistenza statica (in kN) / Resistenza alla rottura (in kN)  
**Statische Festigkeit (in kN) / Bruchfestigkeit (in kN)**

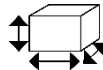

**Dimensions de la structure d'accueil**  
Dimensions of the receiving structure  
**Dimensiones de la estructura receptora**  
Dimensioni della struttura ospitante  
**Abmessungen der Aufnahmestruktur**